

# Plat of Survey

of

A parcel of land described in Title Commitment No. 914060354 prepared by Southeastern Title, LLC, dated June 24, 2014 as shown below:

Lots One (1), Two (2) and Three (3) in Block Twenty-four (24) in Bruce's Addition to the Village of Darien, according to the recorded plat of said Village now on record in the office of the Register of Deeds in and for Walworth County, Wisconsin. Also a parcel of land described as follows to-wit: beginning at the Southwest corner of Lot Three (3) in said Block Twenty-four (24); thence Southwesterly on the extended Southerly line of said Lot Three (3) to the Easterly line of land owned by R.L. Blakely; thence Northwesterly along the Easterly line of said Blakely's land to the Southerly line of the right-of-way of the Chicago, Milwaukee, St. Paul and Pacific Railway; thence Northeasterly along the Southerly line of said right-of-way to the Northwest corner of Lot One (1) in said Block Twenty-four (24); thence Southeasterly along the Westerly line of said Block Twenty-four (24) to the place of beginning. Also the West one-half of Bruce Street lying Northwest of Fremont Street and adjacent and parallel to Lots 1 and 2, Block 24, John Bruce Addition, Village of Darien. Also the East one-half of Bruce Street lying Northwest of Fremont Street, Village of Darien, Walworth County. (A strip of land 33 feet in width adjacent to and parallel with the West line of Lot 11, Block 23, John Bruce Addition, Village of Darien.) Tax Parcel ID #: QBA 00004 Address: 44 Bruce Street

(Former Chicago, Milwaukee & St. Paul Railway Company)  
**Railroad R.O.W.**  
(99' Wide)

Tax Parcel  
QVD 00143

Tax Parcel  
QBA 00004

2.224 Acres  
96,878 Sq.Ft.

Surveyed for:

**Susan Brahm**

P.O. Box 781  
Darien, Wisconsin. 53114

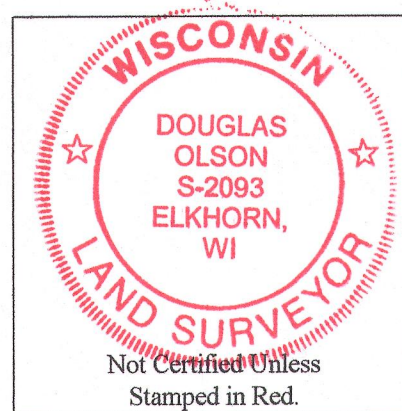

## Notes:

- 1) This survey plat is not certified unless signed and sealed in red ink.
- 2) This survey is subject to Wisconsin lien laws. This Plat of Survey is the notice of intent to file lien. Lien waiver required.

Copyright 2014 by Jensen & Olson Land Surveying, LLC.

All rights reserved. No part of this survey plat may be reproduced or transmitted in any form by any means - graphic, electronic, or mechanical, including photocopying, tracing, or information storage and retrieval systems - without permission in writing from Douglas G. Olson, Jensen & Olson Land Surveying, LLC.

I hereby certify that I have surveyed the above described property and the map hereon is correct to the best of my professional knowledge and belief and shows the size and location of the property, its exterior boundaries, the location and dimensions of all visible structures thereon, boundary fences, apparent easements and roadways and visible encroachments, if any.

This survey is made for the exclusive use of the present owners of the property, and also those who purchase, mortgage or guarantee title thereto, within one year from the date hereof.

Douglas G. Olson  
Wisconsin Registered Land Surveyor - 2093

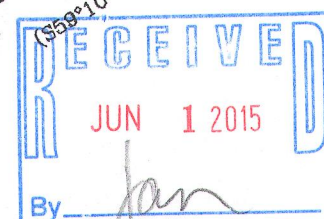

Survey Date: June 24, 2014.  
Revisions: No. 1 - Legal Desc.

Scale in Feet  
1" = 30'

**Jensen & Olson Land Surveying, LLC**  
45 South Wisconsin Street \* P.O. Box 322 \* Elkhorn, Wisconsin. 53121  
Telephone: (262) 723-3434 \* Facsimile: (262) 723-8044  
Email: jensen.olson@elknet.net

**Legend**  
Ø Found Iron Pipe  
○ Set Iron Pipe, 1" dia.  
( ) Recorded Information  
X Utility Pole  
○ Utility Pedestal  
○ Manhole  
○ Asphalt Surface  
○ Concrete Surface

Sheet 1 of 1 Sheets

Job Reference Number  
**2014.058**

2014.058